

# MAXIPLANK® LAP SIDING INSTALLATION GUIDE

*Read all instructions prior to installing any siding product. Failure to install and finish this product in accordance with all local building codes, regulations and MAXITILE® written application instructions may lead to personal injury, affect system performance, violate local building codes, and void the product warranty. Please thoroughly read and understand these instruction prior to installation.*

MAXIPLANK® is available in 5-1/4", 6-1/4", 7-1/4", 8-1/4", 9-1/4", and 12" in Cedar Textured and Smooth Textured.

MAXIPLANK® is also available in 8-1/4" Colonial (Channel Rustic).

MAXIPLANK® Fiber Cement Siding is made with cement and other special ingredients, which make it non-combustible and resistant to termites, hail, and rot.

## STORAGE AND HANDLING:

- Protect from the weather.
- Use the bundle cover that is provided in the pallet to keep dry the product.
- MAXIPLANK® is produced with a factory-applied primer. This primer does not provide adequate resistance to moisture in the event the product is allowed to become saturated during storage. If MAXIPLANK® becomes wet or saturated, allow product to dry before installation.
- Store product dry and flat prior to installation.
- Installing wet or saturated MAXIPLANK® may cause shrinkage at butt joints, which could produce breakage at corners.
- Protect edges and corners from chipping or breakage.
- Carry planks on edge.

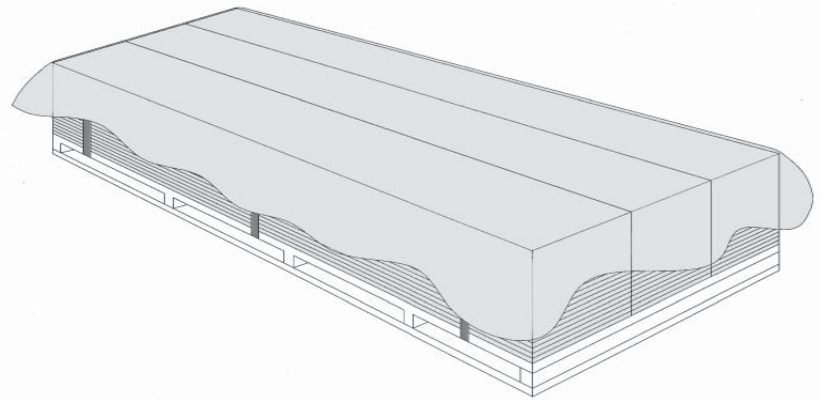

MAXITILE® is not responsible for damage caused by improper storage and handling of the product.

**IMPORTANT:** To prevent damage to the drip edge, extra care should be taken when removing planks from the pallet, while handling, and when installing with a lap gauge. Please see additional handling requirements:

- Planks are interlocked together on the pallet; therefore, they should be removed from the pallet horizontally (side to side) to allow planks to unlock themselves from one another.
- Pull MAXIPLANK® from across the stack. Do not pull planks from the same vertical stack.



**MAXITILE®**  
Fiber Cement Siding & Roofing

BETTER TEXTURE. BETTER PRIMER. BETTER WARRANTY.

## FRAMING:

- Follow Local Building Codes for proper framing and flashing requirements.
- **MAXIPLANK®** can be installed over structural wood framing or steel studs, spaced at 16" on center or at a maximum of 24" on center. When installing **MAXIPLANK®**, the fasteners must penetrate the framing studs at least 1 inch.
- If the wall is sheathed with a minimum 7/16" OSB or plywood sheathing, the fastener lengths must be adjusted to ensure the fasteners will go through the **MAXIPLANK®** product, sheathing, and then penetrate the framing studs at least 1 inch.
- Irregularities in framing and sheathing can telegraph through the finished application.
- Concealed nailing is not allowed at 24" on center, or when installing 12" wide **MAXIPLANK®** Siding at 16" on center.
- A weather resistant barrier between the framing and the siding is required in accordance with Local Building Code requirements. The weather resistant barrier must be installed in accordance with Local Building Code requirements.
- MaxiPlank may only be used as fascia when installed over a solid wood sub-fascia.
- Do not install **MAXIPLANK®** products in any manner that allows contact with standing or running water.
- **MAXIPLANK®** lap siding may be installed horizontally on flat vertical wall applications only.

MAXITILE® will not assume any responsibility for water infiltration within the wall or wall cavity.

## CUTTING:

- If power-sawing, use carbide- or diamond-tipped blade. Contain any dust produced from cutting the product to protect yourself and others.
- Only use power cutting tools in well ventilated areas.
- Use NIOSH approved respirators and goggles for protection when power-sawing.
- For score-and-snap cutting, use a carbide-tipped scoring tool.
- Using a straight edge as a guide, carefully draw the scoring tool up and down several times. Bend upwards and break.
- Specialized fiber cement cutting tools, shears, and guillotines may also be used.
- Round openings can be made by using a holesaw or by drilling several holes around the circumference of the desired opening and tapping out the center.
- NEVER use a power saw indoors.
- NEVER dry sweep any dust or debris. Use wet cleaning methods or HEPA vacuums.

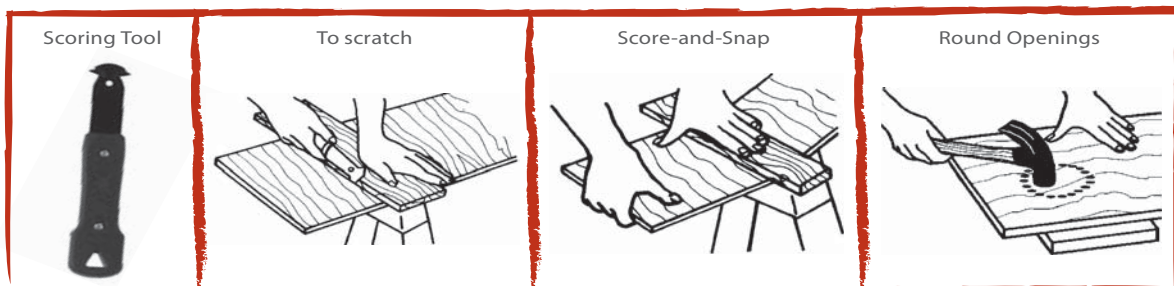
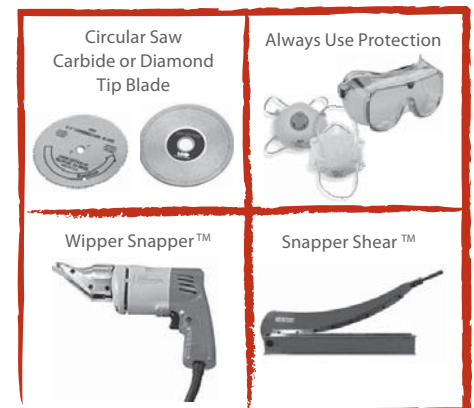

### WARNING: AVOID BREATHING SILICA DUST

MAXITILE® siding products contain respirable crystalline silica, which is known to the State of California to cause cancer and is considered by IARC and NIOSH to be a cause from some occupational sources. Breathing excessive amounts of respirable silica dust can also cause a disabling and potentially fatal lung disease called silicosis, and has been linked with other diseases. Some studies suggest smoking may increase these risks. During installation or handling: (1) work in outdoor areas with ample ventilation; (2) use fiber cement shears for cutting or, where not feasible, use a dust-reducing circular saw attached to a HEPA vacuum; (3) warn others in the immediate area; (4) wear a properly-fitted, NIOSH-approved dust mask or respirator (e.g. N-95) in accordance with applicable government regulations and manufacturer instructions to further limit respirable silica exposures. During clean-up, use HEPA vacuums or wet methods, never dry sweep. For further information, refer to our installation guides and Material Safety Data Sheet available at [www.maxitile.com](http://www.maxitile.com) or by calling (800) 451-2003. FAILURE TO ADHERE TO OUR WARNINGS, MSDS, AND INSTALLATION GUIDES MAY CAUSE SERIOUS PERSONAL INJURY OR DEATH.

## FASTENERS:

Fasteners must be corrosion-resistant, preferably hot dipped galvanized, nails. MAXITILE® is not responsible for corrosion resistance of fasteners. Stainless steel fasteners are recommended when installing MAXITILE® products near the ocean.

- Drive fasteners perpendicular to siding and framing.
- Do not over-drive nail heads or drive nails at an angle.
- If nail is overdriven and/or breaks the surface of the product, caulk the nail hole and install another nail so that it is flush with the surface.
- Do not use aluminum fasteners, staples, or clipped head nails.
- If nail penetrates sheathing only, the warranty may be voided.
- Nails must always hit framing studs, penetrating a minimum of 1 inch into solid wood.
- When hand-nailing, pre-drill the holes at the corners to avoid accidental breakage.
- Nails can be applied using a pneumatic nail gun with a flush attachment or a smooth head hammer.
- MAXIPLANK® lap siding can be installed over up to a 1" thick foam insulation/sheathing. Take extra precaution (especially if using a pneumatic nail gun) to not over-drive the fasteners, or it could compress the foam and cause dimples in the siding.
- For special fastening applications, please email [technical.support@maxitile.com](mailto:technical.support@maxitile.com).



### Concealed Fastening:

#### Wood Framing Fasteners

- Siding Nail (.09" shank x .221" HD x 2" long)
- 11 ga. roofing nail (.121" shank x .371" HD x 1.75" long)

#### Steel Framing Fasteners

- Screws: Ribbed Wafer-head or equivalent (No. 8 x .375 HD x 1.5" long) Screws must penetrate at least 3 threads

### Exposed Fastening:

#### Wood Framing Fasteners

- Siding Nail (.09" shank x .221" HD x 2" long)
- 6d (.113" shank x .267" HD x 2" long)

#### Steel Framing Fasteners

- Screws: Ribbed Wafer-head or equivalent (No. 8 x .375 HD x 1.5" long) Screws must penetrate at least 3 threads

### Correct

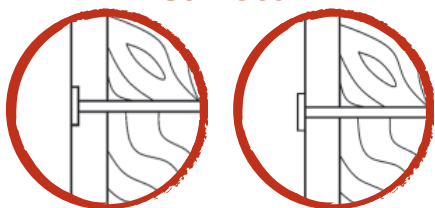

### Incorrect

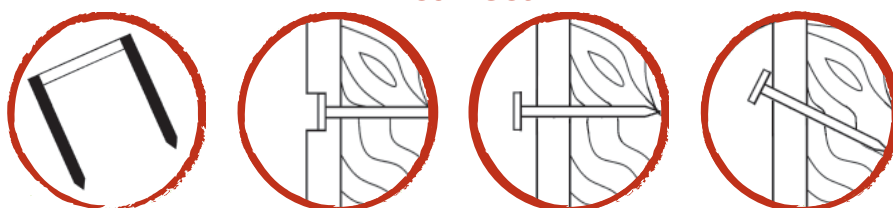

**NOTE:** Published wind loads may not be applicable to all areas where Local Building Codes have specific jurisdiction. Consult MAXITILE® Technical Assistance if you are unsure of applicable compliance documentation.

## CONCEALED FASTENING:

- Fasteners must be installed a minimum of 1-inch from the top of every piece of MAXIPLANK®, and must penetrate a minimum of 1 inch into solid wood.
- It is important to keep nails level and flush for proper siding installation.
- Firmly hold the siding against the wall while nailing, especially at the butt joints.

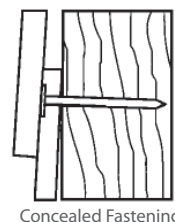

## EXPOSED FASTENING:

- Fasteners must be installed between ¾-inch and 1 inch from the bottom edge of every piece of MAXIPLANK®, and must penetrate a minimum of 1 inch into solid wood.
- It is important to keep nails level and flush for proper siding installation.
- Firmly hold the siding against the wall while nailing, especially at the butt joints.

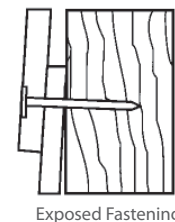

## KICKOUT FLASHING:

- Because of the volume of water that can pour down a sloped roof, one of the most critical flashing details occurs where a roof intersects a sidewall.
- The roof line must be flashed with step flashing.
- Where the roof terminates, install kickout flashing to deflect water away from the siding.
- Follow Local Building Codes for kick out flashing and other flashing requirements.

## INSTALLATION:

- Fasten fiber cement, metal, or rot resistant trim at all interior and exterior corners.
- Install a rot resistant starter strip that is 1 ½ inches wide x 1/4 inch thick to the sill plate prior to installing the first course.
- Locate and mark stud locations to be sure that all nails will hit studs and penetrate at least 1 inch.
- Starting at a corner and leaving 1/8" gap from the trim, install the first course level to the base of the starter strip. Butt the next **MAXIPLANK®** with moderate contact to the preceding piece.
- At the end of the course, score-snap or cut the **MAXIPLANK®** to fit. Leave an 1/8" gap at all trim, and/or windows and doors.
- Caulking at butt joints is not recommended. If caulking, make sure to apply caulking per the manufacturers recommended installation instructions.
- **Joint-flashing at the butt joints is recommended instead of caulking.**
- To begin the next course, use a lap gauge tool, a chalk line, or a self aligning clip to set the overlap at 1 ¼", which is the minimum allowed.
- Vertical joints must be staggered a minimum of 16" from adjacent courses.
- All **MAXIPLANK®** must span over a minimum of two studs except when using the "off-stud joiner."
- All exposed field cut edges (such as butt joints, outside edges or where joint flashing is used) should be covered with primer, sealant or paint.
- **ALL BUTT JOINTS MUST BE CENTERED OVER A STUD UNLESS USING OFF-STUD JOINERS.**

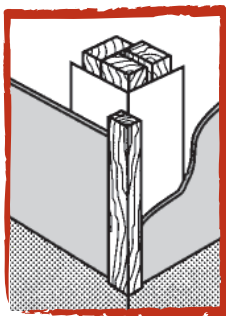

External Corner

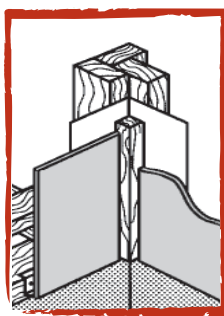

Internal Corner

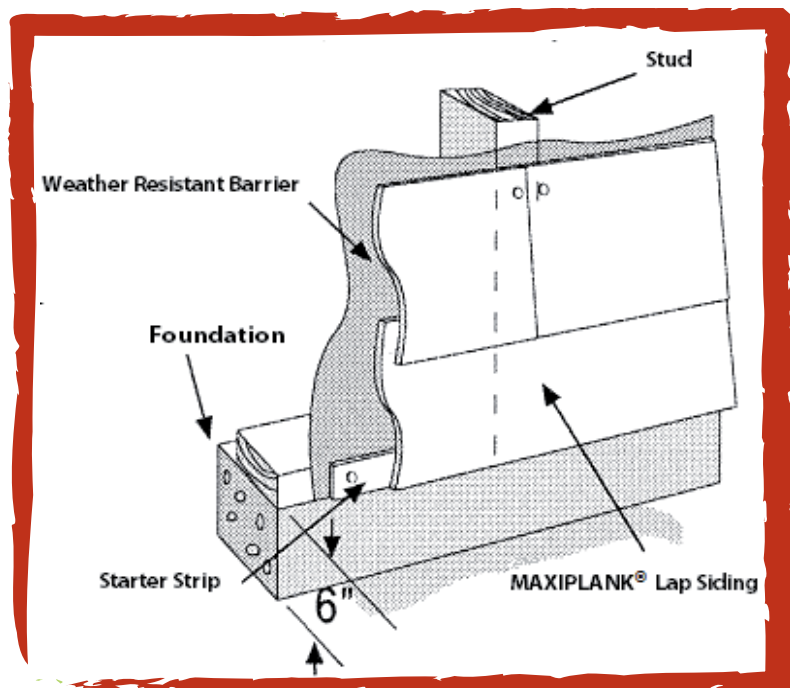

## CLEARANCES:

**MAXIPLANK®** should be installed to meet Local Building Code clearance requirements between the bottom edge of the **MAXIPLANK®** and the adjacent finished grade. These clearances ensure the long-term durability of the products and the buildings on which they are installed. Failure to provide the proper clearances may void the warranty on the product.

- A 6" minimum clearance above finished grade is required.
- Maintain a 1" - 2" clearance between **MAXITILE®** products and paths, steps and driveways.
- Maintain a 1" - 2" clearance between **MAXITILE®** products and decking material.
- At the juncture of the roof and vertical surfaces, flashing and counterflashing shall be installed per the roofing manufacturer's instructions. Provide a 1" - 2" clearance between the roofing and the bottom edge of the siding and trim.
- Maintain a ¼" clearance between the bottom of **MAXITILE®** products and horizontal flashing.
- Maintain a minimum 1" gap between gutter end caps and siding and trim.

## OFF-STUD BUTT JOINT INSTALLATION:

- The off-stud joiner is placed halfway onto the end of the plank with the flashing portion of the joiner touching the back of the siding. The lower tabs are then positioned over the previous course. The adjoining piece must have moderate contact at the butt joint.
- **MAXIPLANK®** must be fastened to all studs.
- Use of the off-stud joiner can eliminate up to 40% of cutting and 10% of waste.
- It ensures correct 1 ¼ inch overlap, saves on saw blades, creates less dust, and reduces the risk for breakage at corners.
- This method is optional.

Off-Stud Joiner



Off-Stud Joining System

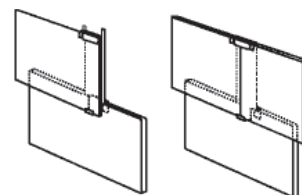

## FINISHING:

- **Patching:**
  - Repair chips and dents with acrylic patching mortar.
  - Prime patched areas before coating with a final finish topcoat.
- **Caulking:**
  - Use high quality exterior grade paintable elastomeric joint sealant, complying with ASTM-C 834 or ASTM-C 920 (grade NS, class 25) regulations. Caulking must be applied according to manufacturer's written instructions or ASTM-C 1193.
- **Painting:**
  - A small amount of material should be painted and evaluated to ensure satisfaction with the appearance before painting all material needed for the job.
  - Never apply oil-based paints or stains to MAXITILE® products. Stains containing linseed oil are specifically designed for wood and are not suitable for or allowed on fiber cement.
  - There are some semi-transparent stain product application methods that will void the **MAXIPLANK®** Warranty. Certain finishing techniques with 100% acrylic latex based paints may be able to replicate a stain-like appearance. Contact MAXITILE® or the paint manufacturer if further clarification is needed.
  - Before applying the finish paint, please ensure the product is clean and dry. Use a high quality 100% acrylic latex paint. Never apply primer or paint to **wet** or **saturated** fiber cement products.
  - All fiber cement products must be painted once installed. **MAXIPLANK®** must be painted within 180 days (6 months) of the initial installation date or the warranty will be voided.
  - All exposed field cut edges should be covered with a high quality 100% acrylic latex primer or paint.
  - Caulking should be paintable or color matched, and should be compatible with MAXITILE® siding and the material used for the trim.
  - Apply finish paint in accordance with paint manufacturers' written instructions regarding application methods, temperature, and other relevant parameters.

MAXITILE® will not warrant and does not assume any responsibility for the performance or appearance of field-applied primer and/or paint.



APPROVALS: In accordance with ICC-ES Legacy Report ESR-1381, **MAXIPLANK®** lap siding is compliance with the following codes: 2006 International Building Code (IBC) and 2006 International Residential Code (IRC) . **MAXIPLANK®** lap siding is also recognized for application in the following: State of Florida listing FL # 11009, U.S. Dept. of HUD Materials Release 1338, Texas Department of Insurance Product Evaluation EC-56, and listing in Wildland Urban Interface Handbook (WUI). These documents should also be consulted for additional information concerning the suitability of this product for specific applications.

Additional Installation Information, Warranties, and Warnings are available at [www.maxitile.com](http://www.maxitile.com)

## MAXIMUM WIND LOADS 5/16 INCH THICK MAXIPLANK®

Wide (inches)	Fastener Type	Frame Type	Stud Spacing (inches)	Height of Building (feet)	Maximum basic wind speed (mph) for exposure category <sup>1</sup>					
					IBC, IRC <sup>2</sup>			UBC <sup>3</sup>		
					B	C	D	B	C	D
max. 12	No. 11 gauge 2.087 inch long galvanized roofing nails <sup>4</sup>	2 by 4 Wood	16"	15	125	100	85	105	80	70
				20	120	100	85	100	80	70
				40	110	90	--	90	75	--
				60	105	85	--	85	70	--
				100	--	--	--	--	--	--
max. 9 ½	No. 11 gauge 1 ¾ inch long galvanized roofing nails <sup>5</sup>	2 by 4 Wood	16"	15	130	100	85	110	80	70
				20	120	100	85	100	80	70
				40	115	90	--	95	75	--
				60	110	85	--	90	70	--
				100	100	--	--	80	--	--
max. 9 ½	No. 8 by 1 ½ inch long RPI C/drill screws	No. 20 gauge by 3 ⅝ inch by 1 ⅝ inch metal C/stud	16", 24"	200	85	--	--	70	--	--
				15	140	120	105	120	100	85
				20	140	120	100	120	100	80
				40	140	110	100	120	90	80
				60	130	105	85	110	85	75
max. 9 ½	No. 8 by 1 ¼ inch long RPI C/drill screws	No. 20 gauge by 3 ⅝ inch by 1 ⅝ inch metal C/stud	16", 24"	100	120	100	85	100	80	70
				200	110	90	--	90	75	70
				15	120	90	--	100	75	--
				20	110	85	--	90	70	--
				40	105	--	--	85	--	--
max. 9 ½				60	100	--	--	80	--	--
				100	85	--	--	70	--	--

1. N/A – not applicable

2. Basic wind speed is the 3-second gust, miles per hour (km/hr), in accordance with IBC Section 1609.3 and IRC Section R301.2.

3. Basic wind speed is the fastest mile speed in accordance with UBC Section 1616.

4. No. 11 gauge nails has 0.125 inch diameter shank and 0.275 inch diameter head.

5. No. 11 gauge galvanized roofing nail has 0.120 inch diameter shank and 0.385 inch diameter head.



**MAXITILE®**  
Fiber Cement Siding & Roofing

15055 Woodham Drive, Houston, Texas 77073

Phone: (800) 451-2003 - Fax: (888) 308-2214

Email: [customer.service@maxitile.com](mailto:customer.service@maxitile.com)